

EXPEDITED SUPPLEMENTAL GROUNDWATER WELL PERMIT APPLICATION



This application is for a permit to construct a supplemental groundwater irrigation water well within the Central Platte Natural Resources District Groundwater Management Area

THIS APPLICATION WILL BE RETURNED IF NOT TOTALLY COMPLETED

Well Driller: _____
 Address: _____

 Telephone: _____

Name _____
 Address _____

 Telephone (_____) _____

Specifications of Intended Well and Pump:
 _____ Approximate date construction will begin.
 Pump column diameter: _____ inches
 Estimated total well depth: _____ feet.
 Estimated pumping capacity: _____ gallons per minute
 Well casing diameter: _____ inches.
 In what formation will screen be placed:
 _____ Upper _____ Lower _____ Both
 Expected well log, if known.
 Provide a copy of test drilling report, if available.

Identify Location of Proposed Well:
 County _____ Township _____ North,
 Range _____ West, Section _____
 GPS Reading of Proposed Well: (If Available)
 Latitude _____ Longitude _____

NRD USE ONLY

PERMIT # CPSG _____
 REG # _____

The box below represents 1 square mile (section). Indicate with an "X" the proposed location of the well. If the well is to be used for irrigation, indicate the location of the lands to be irrigated.

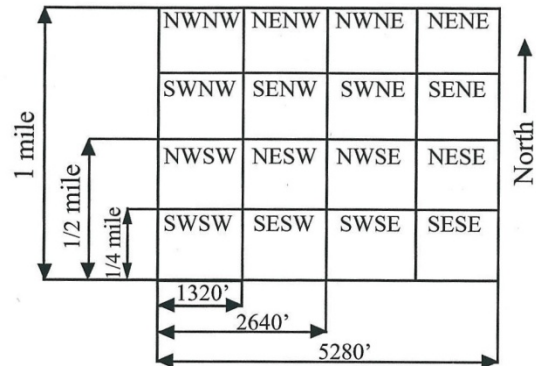

The well will be located _____ feet from the _____ (North/South) section line and _____ feet from the _____ (East/West) section line.

How many acres will be irrigated? _____

Is all of the land previously certified irrigated?

___ Yes ___ No If yes, with:
 ___ Groundwater- Number of Acres _____
 ___ Surface Water- Number of Acres _____

Are you increasing or decreasing the irrigated acres?

___ Yes ___ No ___ Increasing ___ Decreasing
 If yes, how many acres? _____

****SEE PERMIT RESTRICTIONS****

Read and sign below & also on back page.

I certify that I am familiar with the information in this application, and that to the best of my knowledge and belief such information is true, complete and accurate.

Date _____ Signature of Applicant _____
 Date Approved _____ Signature of NRD Representative _____

ENCLOSE: \$50.00 FILING FEE

EXPEDITED SUPPLEMENTAL GROUNDWATER WELL PERMIT APPLICATION

This permit is approved with the understanding that the landowner will agree and abide by the following conditions:

1. This water well will be used to supplement irrigation wells that irrigate lands already irrigated with groundwater and that the irrigated acres will not exceed the acres currently irrigated.

The Rules and Regulations of the Groundwater Use in Fully and Over Appropriated Areas and the above Conditional Use Permit will be enforced by the District through the use of cease and desist orders issued in Accordance with the Rules and Regulations for the enforcement of the Groundwater Management Plan adopted July 23, 1987 and subsequently amended. In accordance with Neb. Rev. Stat § 46-656.10 (cum.supp. 2003), any person who violates a cease and desist order issued by the district shall be subject to a civil penalty of not less than one thousand dollars and not more than five thousand dollars for each day an intentional violation occurs.

I have read and understand that in order to obtain this well permit, drill the supplemental well, and use the supplemental well, that I must comply with Central Platte Natural Resources District's Rules and Regulations of the Groundwater Use in Fully and Over-Appropriated Areas, which include the conditions stated above.

Landowner Signature

Date

This permit is not a Variance to expand irrigated acres. No new irrigated acres are allowed in the Central Platte Natural Resources District (CPNRD) without offsetting other irrigated acres and getting an approved Variance from the CPNRD.

Required Information for Expedited Supplemental Groundwater Well Permit
within the Central Platte Natural Resources District's Suspension of Well Drilling Areas

This is only for new wells used to irrigate land previously irrigated with groundwater and is not intended to be used to add any newly irrigated acres.

Please provide the following:

- ✓ A completed Water Well Permit Application provided by the Central Platte NRD and pay a fee of \$50.00 (non-fundable).
- ✓ Information on wells used to irrigate this land. This information could include registration with the Nebraska Department of Natural Resources (location and owner). The information is available online at: www.dnr.ne.gov or at the Central Platte NRD office.
- ✓ Other information that may be requested by the NRD.



Send this application and the \$50.00 (non-refundable) filing fee to:

Central Platte Natural Resources District 215 Kaufman Ave Grand Island NE 68803

Please take the time to fill out the information correctly. The District will return an incomplete or inaccurate application, with 60 days being allowed to return the application. The District shall issue all permits with conditions attached or denied no later than 30 days after receipt of a complete and properly prepared application.

PERMIT RESTRICTIONS

1. A well permit is required prior to construction. The District must approve the permit application prior to starting any well construction activities.
2. If the well authorized by this permit is for irrigation, the well may not be constructed closer than 600 feet from another landowner's existing registered irrigation well, unless a special spacing permit (Neb. Rev. Stat. § 46-610) has been granted from the Nebraska Department of Natural Resources. No irrigation well may be constructed closer than 1,000 feet from an existing industrial or municipal well and no industrial or municipal well may be constructed within 1,000 feet of any other existing well, unless a special spacing permit (Neb. Rev. Stat. § 46-653) has been granted from the Nebraska Department of Natural Resources or if they are owned by the same individual.
3. If it is later determined that offsets have to be made because of any depletions to the river caused by the well that was put in under the variance, whatever offsets have to be made will be the well owner's responsibility to make.
4. This permit does not register the well with the Nebraska Department of Natural Resources. All wells are required to be registered with the Nebraska Department of Natural Resources within 60 days after the well is completed.
5. If the well is not constructed within a one-year period from the date of approval, a new permit is needed.
6. According to Neb. Rev. Stat. § 46-637, water wells may not be drilled within 50 feet of a stream bank without first getting a surface water right for that stream from the Nebraska Department of Natural Resources.
7. Any person who, on or after August 30, 1981, commences or causes construction of such a well for which the required permit has not been obtained, or who knowingly furnishes false information regarding such permit, shall be guilty of Class IV misdemeanor. (Neb. Rev. Stat. § 46-602.01)
8. Permits are not required for test holes, temporary dewatering wells (less than 90 days), or wells designed to pump 50 gallons per minute or less. *If possible mark (with a flag) the well site in the field.*

COMMENTS/RESTRICTIONS: