



# INDUSTRIAL WATER WELL PERMIT APPLICATION

CPNRD-12/11

*This application is for a permit to construct an industrial water well within the Central Platte Natural Resources District Groundwater Management Area*  
**THIS APPLICATION WILL BE RETURNED IF NOT TOTALLY COMPLETED.**

**Well Driller** \_\_\_\_\_  
 Address: \_\_\_\_\_  
 \_\_\_\_\_  
 Telephone: \_\_\_\_\_

**NRD USE ONLY**  
 PERMIT # CPIN \_\_\_\_\_  
 REG # \_\_\_\_\_

**1. Name** \_\_\_\_\_  
 Address \_\_\_\_\_  
 \_\_\_\_\_  
 Telephone (\_\_\_\_\_) \_\_\_\_\_

**2. Replacement Well Information:**  
 New well is \_\_\_\_\_ feet from the old well.  
 Well registration number of old well: \_\_\_\_\_

**3. Specifications of Intended Well and Pump:**  
 \_\_\_\_\_ Approximate date construction will begin.  
 Pump column diameter: \_\_\_\_\_ inches  
 Estimated total well depth: \_\_\_\_\_ feet.  
 Estimated pumping capacity: \_\_\_\_\_ gallons per minute  
 Well casing diameter: \_\_\_\_\_ inches.  
 In what formation will screen be placed:  
 \_\_\_\_\_ Upper \_\_\_\_\_ Lower \_\_\_\_\_ Both  
 Expected well log, if known.  
 \*Provide a copy of test drilling report, if available\*

**3. Identify Location of Proposed Well:**  
 County \_\_\_\_\_ Township \_\_\_\_\_ North,  
 Range \_\_\_\_\_ West, Section \_\_\_\_\_  
 GPS Reading of Proposed Well: (If Available)  
 Latitude \_\_\_\_\_  
 Longitude \_\_\_\_\_

The box below represents 1 square mile (section)  
**With an "X" the proposed location of the well.**  
**Indicate the location of the lands to be irrigated.**

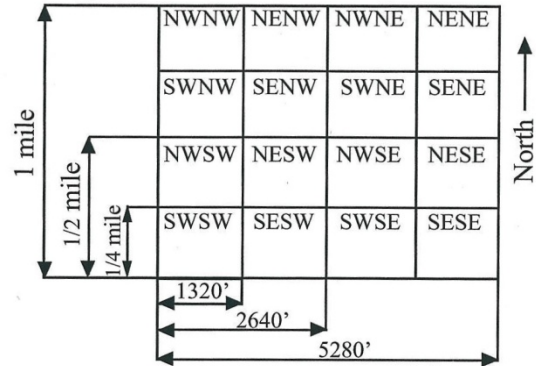

The well will be located \_\_\_\_\_ feet from the \_\_\_\_\_ (North/South) section line and \_\_\_\_\_ feet from the \_\_\_\_\_ (East/West) section line.

**5. Expected Yield of Well:**  
 Annual Output: \_\_\_\_\_  
 Seasonal Output: \_\_\_\_\_

**6. Amount of Water Consumed:**  
 Annual Consumption: \_\_\_\_\_  
 Seasonal Consumption: \_\_\_\_\_

**7. Are you increasing the present (historical) pumping rate?** \_\_\_\_\_ Yes How many GPM? \_\_\_\_\_  
 \_\_\_\_\_ No

*I certify that I am familiar with the information in this application, and that to the best of my knowledge and belief such information is true, complete and accurate.*

Date \_\_\_\_\_ Signature of Applicant \_\_\_\_\_  
 Date Approved \_\_\_\_\_ Signature of NRD Representative \_\_\_\_\_

**ENCLOSE: \$50.00 FILING FEE**

**\*\*SEE PERMIT RESTRICTIONS ON BACK\*\***



**Send this application and the \$50.00 non-refundable filing fee to:**  
**Central Platte NRD 215 Kaufman Ave Grand Island NE 68803**

Please take the time to fill out the information correctly. The District will return an incomplete or inaccurate application, with 60 days being allowed to return the application. The District shall issue all permits with conditions attached or denied no later than 30 days after receipt of a complete and properly prepared application.

### **PERMIT RESTRICTIONS**

1. A well permit is required prior to construction. The District must approve the permit application prior to starting any well construction activities.
2. This well may not be constructed closer than 600 feet from another landowner's existing registered irrigation well, unless a special spacing permit (Neb. Rev. Stat. § 46-610) has been granted from the Nebraska Department of Natural Resources. No irrigation well may be constructed closer than 1,000 feet from an existing industrial or municipal well and no industrial or municipal well may be constructed within 1,000 feet of any other existing well, unless a special spacing permit (Neb. Rev. Stat. § 46-653) has been granted from the Nebraska Department of Natural Resources or if they are owned by the same individual.
3. This permit does not register the well with the Nebraska Department of Natural Resources. All wells are required to be registered with the Nebraska Department of Natural Resources within 60 days after the well is completed.
4. If the well is not constructed within a one-year period from the date of approval, a new permit is needed.
5. According to Neb. Rev. Stat. § 46-637, water wells may not be drilled within 50 feet of a stream bank without first getting a surface water right for that stream from the Department of Natural Resources.
6. Any person who, on or after August 30, 1981, commences or causes construction of such a well for which the required permit has not been obtained, or who knowingly furnishes false information regarding such permit, shall be guilty of a Class IV misdemeanor. (Neb. Rev. Stat. § 46-602.01)
7. Permits are not required for test holes, temporary dewatering wells (less than 90 days), or wells designed to pump 50 gallons per minute or less. *If possible mark (with a flag) the well site in the field.*

**Additional Restrictions:** Any reduction in consumptive use associated with new non-municipal industrial or commercial uses of less than twenty-five million gallons, during the period between the operative date of this section and January 1, 2026, shall accrue to the benefit of the natural resources district within which such non-municipal industrial or commercial user is located.

**Source:** Laws 1982, LB 375, § 12; Laws 1991, LB 51, § 5; Laws 1993, LB 439, § 3; R.S.1943, (1993), § 46 673.10; Laws 1996, LB 108, § 32; Laws 2001, LB 135, § 3; R.S.Supp., 2002, § 46-656.26; Laws 2004, LB 962, § 80; Laws 2006, LB 1226, § 28. Operative date: July 14, 2006.

### **COMMENTS/RESTRICTIONS:**