



TRANSFER LOCATION OF GROUNDWATER USE WATER WELL PERMIT APPLICATION

This application is for a permit to construct a transfer use water well within the Central Platte Natural Resources District Groundwater Management Area

THIS APPLICATION WILL BE RETURNED IF NOT TOTALLY COMPLETED and will not be approved until a variance has been granted by the Central Platte NRD.

Well Driller _____
Address: _____

Telephone: _____

NRD USE ONLY
PERMIT # CPTF _____
REG # _____

1. Name _____
Address _____

Telephone (_____) _____

2. Specifications of Intended Well and Pump:
 _____ Approximate date construction will begin.
 Pump column diameter: _____ inches
 Estimated total well depth: _____ feet.
 Estimated pumping capacity: _____ gallons per minute
 Well casing diameter: _____ inches.
 In what formation will screen be placed:
 _____ Upper _____ Lower _____ Both
 Expected well log, if known.
 Provide a copy of test drilling report, if available

3. Identify Location of Proposed Well:
 County _____ Township _____ North,
 Range _____ West, Section _____
 GPS Reading of Proposed Well: (If Available)
 Latitude _____
 Longitude _____

The box below represents 1 square mile (section).
With an "X" the proposed location of the well.
Indicate the location of the lands to be irrigated.

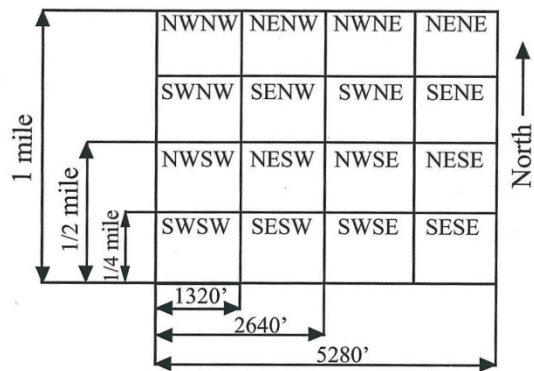

The well will be located _____ feet from the _____ (North/South) section line and _____ feet from the _____ (East/West) section line.

4. How many total acres will be irrigated? _____

5. Is the land currently irrigated? Yes No
 If yes, how many acres? _____

6. The water (offset) is being transferred from:
 Owners Name _____
 Township _____ Range _____ Section _____ Co. _____
 How many acres? _____

****SEE PERMIT RESTRICTIONS ON BACK****
BACK PAGE NEEDS TO BE READ & SIGNED

I certify that I am familiar with the information in this application, and that to the best of my knowledge and belief such information is true, complete and accurate.

Date _____ Signature of Applicant _____
 Date Approved _____ Signature of NRD Representative _____

ENCLOSE: \$50.00 FILING FEE

Transfer Location of Use: This permit is approved with the understanding that the landowner will agree and abide by the following conditions:

1. This is a permit to drill and is not to be mistaken for a Variance that would allow newly irrigated acres to be irrigated and will not be valid prior to receiving an approved variance from the Central Platte NRD.
2. If it is later determined that offsets have to be made because of any depletions to the river caused by the well that was put in under the variance, whatever offsets have to be made will be the well owner's responsibility to make.
3. Other:

The Rules and Regulations for Groundwater Use in Fully and Over Appropriated Areas and the above Transfer Permit will be enforced by the District through the use of cease and desist orders issued in Accordance with the Rules and Regulations for the enforcement of the Groundwater Management Plan adopted July 23, 1987 and subsequently amended. In accordance with Neb. Rev. Stat § 46-656.10 (cum.supp. 2003), any person who violates a cease and desist order issued by the district shall be subject to a civil penalty of not less than one thousand dollars and not more than five thousand dollars for each day an intentional violation occurs.

I have read and understand that in order to obtain this well permit, drill the conditional use well, and use the conditional use well, I must comply with Central Platte Natural Resources District's Rules and Regulations of the Temporary Suspension of Groundwater Wells, which includes the condition stated above.

Landowner Signature

Date

This Permit is not a Variance to expand irrigated acres. No new irrigated acres are allowed in the Central Platte Natural Resources District (District) without offsetting other irrigated acres and getting an approved Variance from the District.

Required Information for a Transfer Permit:

This is a permit to drill and is not to be mistaken for a Variance that would allow newly irrigated acres to be irrigated and will not be valid prior to receiving an approved Variance from the Central Platte NRD. Please provide the following:

- ✓ Complete a Water Well Permit Application, provided by the NRD and pay a non-refundable fee of \$50.00.
- ✓ If an irrigation well(s) is taken out of operation the appropriate forms (decommissioning, inactive status etc.) will need to be submitted to the Nebraska Department of Natural Resources.
- ✓ Other information that may be requested by the NRD.

This agreement will be strictly enforced and any violations will be subject to cease and desist orders and a fine of up to \$5,000.00 per day of the violation.



Send this application and the \$50.00 non-refundable filing fee to:
Central Platte NRD 215 Kaufman Ave Grand Island NE 68803

Please take the time to fill out the information correctly. The District will return an incomplete or inaccurate application, with 60 days being allowed to return the application. The District shall issue all permits with conditions attached or denied no later than 30 days after receipt of a complete and properly prepared application.

PERMIT RESTRICTIONS

1. A well permit is required prior to construction. The District must approve the permit application prior to starting any well construction activities.
2. This well may not be constructed closer than 600 feet from another landowner's existing registered irrigation well, unless a special spacing permit (Neb. Rev. Stat. § 46-610) has been granted from the Department of Natural Resources. No irrigation well may be constructed closer than 1,000 feet from an existing industrial or municipal well and no industrial or municipal well may be constructed within 1,000 feet of any other existing well, unless a special spacing permit (Neb. Rev. Stat. § 46-653) has been granted from the Department of Natural Resources or if they are owned by the same individual.
3. This permit does not register the well with the Department of Natural Resources. All wells are required to be registered with the State Department of Natural Resources within 60 days after the well is completed.
4. If the well is not constructed within a one-year period from the date of approval, a new permit is needed.
5. According to Neb. Rev. Stat. § 46-637, water wells may not be drilled within 50 feet of a stream bank without first getting a surface water right for that stream from the Department of Natural Resources.
6. Any person who, on or after August 30, 1981, commences or causes construction of such a well for which the required permit has not been obtained, or who knowingly furnishes false information regarding such permit, shall be guilty of a Class IV misdemeanor. (Neb. Rev. Stat. § 46-602.01)
7. Permits are not required for test holes, temporary dewatering wells (less than 90 days), or wells designed to pump 50 gallons per minute or less. *If possible mark (with a flag) the well site in the field.*

COMMENTS/RESTRICTIONS: