



# LIVESTOCK WELL (OVER 50 GPM) PERMIT APPLICATION

*This application is for a permit to construct a domestic water well within the Central Platte Natural Resources District Groundwater Management Area*

**THIS APPLICATION WILL BE RETURNED IF NOT TOTALLY COMPLETED**

Well Driller: \_\_\_\_\_  
 Address: \_\_\_\_\_  
 \_\_\_\_\_  
 Telephone: \_\_\_\_\_

**NRD USE ONLY**  
 PERMIT # CP \_\_\_\_\_ L  
 REG # \_\_\_\_\_

**1. Name** \_\_\_\_\_  
 Address \_\_\_\_\_  
 \_\_\_\_\_  
 Telephone (\_\_\_\_\_) \_\_\_\_\_

**2. Specifications of Intended Well and Pump:**  
 \_\_\_\_\_ Approximate date construction will begin.  
 Pump column diameter: \_\_\_\_\_ inches  
 Estimated total well depth: \_\_\_\_\_ feet.  
 Estimated pumping capacity: \_\_\_\_\_ gallons per minute  
 Well casing diameter: \_\_\_\_\_ inches.  
 In what formation will screen be placed:  
 \_\_\_\_\_ Upper \_\_\_\_\_ Lower \_\_\_\_\_ Both  
 Expected well log, if known.  
 \*Provide a copy of test drilling report, if available.\*

**3. Identify Location of Proposed Well:**  
 County \_\_\_\_\_ Township \_\_\_\_\_ North,  
 Range \_\_\_\_\_ West, Section \_\_\_\_\_  
 GPS Reading of Proposed Well (If available):  
 Latitude \_\_\_\_\_  
 Longitude \_\_\_\_\_

The box below represents 1 square mile (section).  
**With an "X" indicate proposed location of the well.**  
**Indicate the location of the lands to be irrigated.**

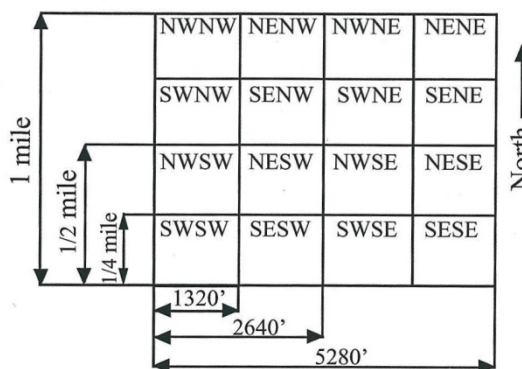

The well will be located \_\_\_\_\_ feet from the \_\_\_\_\_ (North/South) section line and \_\_\_\_\_ feet from the \_\_\_\_\_ (East/West) section line.

**4. Expected Yield of Well**  
 Annual Output: \_\_\_\_\_  
 Seasonal Output: \_\_\_\_\_

**5. Amount of Water Consumed**  
 Annual Output: \_\_\_\_\_  
 Seasonal Output: \_\_\_\_\_

**6. Type of Livestock** \_\_\_\_\_

**7. Number of Livestock** \_\_\_\_\_

**\*\*SEE PERMIT COMMENTS/RESTRICTIONS AND DEFINITIONS ON BACK\*\***

*I certify that I am familiar with the information in this application, and that to the best of my knowledge and belief such information is true, complete and accurate.*

Date \_\_\_\_\_ Signature of Applicant \_\_\_\_\_  
 Date Approved \_\_\_\_\_ Signature of NRD Representative \_\_\_\_\_

**ENCLOSE: \$50.00 FILING FEE**



**Send this application and the \$50.00 non-refundable filing fee to:**  
**Central Platte NRD 215 Kaufman Ave Grand Island NE 68803**

Please take the time to fill out the information correctly. The District will return an incomplete or inaccurate application, with 60 days being allowed to return the application. The District shall issue all permits with conditions attached or denied no later than 30 days after receipt of a complete and properly prepared application.

### **PERMIT RESTRICTIONS**

1. A well permit is required prior to construction. The District must approve the permit application prior to starting any well construction activities.
2. This permit does not register the well with the Nebraska Department of Natural Resources. All wells are required to be registered with the Nebraska Department of Natural Resources within 60 days after the well is completed.
3. If the well is not constructed within a one-year period from the date of approval, a new permit is needed.
4. According to Neb. Rev. Stat. § 46-637, water wells may not be drilled within 50 feet of a stream bank without first getting a surface water right for that stream from the Department of Natural Resources.
5. Any person who, on or after August 30, 1981, commences or causes construction of such a well for which the required permit has not been obtained, or who knowingly furnishes false information regarding such permit, shall be guilty of a Class IV misdemeanor. (Neb. Rev. Stat. § 46-602.01)
6. Permits are not required for test holes, temporary dewatering wells (less than 90 days), or wells designed to pump 50 gallons per minute or less. *If possible mark (with a flag) the well site in the field.*
7. All county, state, and federal regulations must be followed.

### **COMMENTS/RESTRICTIONS:**

